



# WE'VE GOT YOUR NUMBER

Download the myCardioMEMS™ App  
today for better peace of mind.

Abbott is here to help you and your doctor stay in touch — because heart failure (HF) should be more than manageable. It should feel like a partnership, which is why we want to make sure you're connected with the myCardioMEMS™ App.

## CLOSER **COMMUNICATION**

Before you feel any symptoms or have to go to the hospital, you can get messages from your doctor. This includes lifestyle modifications and what medication changes you should make. You can also designate a caregiver to receive and respond to messages and help you keep track of your care.

## CONSTANTLY **CONNECTED**

The myCardioMEMS™ App lets you see your real-time reading transmission status and view your monthly history of transmissions and messages.



The myCardioMEMS™ App can be downloaded from the App Store® for your iPhone® mobile digital device and on Google Play® for your Android® device.



# WITH THE MYCARDIOMEMS™ APP YOU CAN:

## GET CUSTOM MESSAGES

with specific guidance based on your reading.

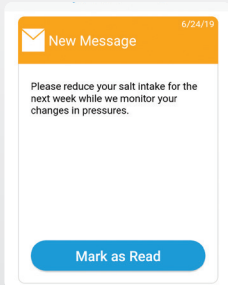

## GET REMINDERS

to take your heart failure medication.

## VIEW MONTHLY HISTORY

of transmissions and messages from clinics.

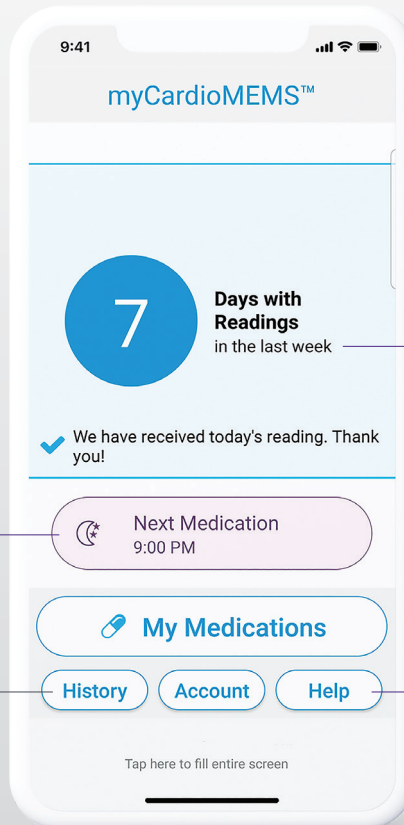
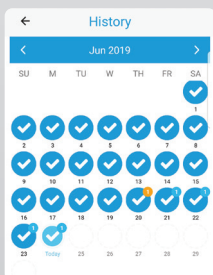

**SEE REAL-TIME TRANSMISSION STATUS** of your CardioMEMS™ HF System readings.

**WATCH TUTORIALS** to learn as you go.

## RECEIVE NOTIFICATIONS

from your clinic to adjust your heart failure medications based on your pulmonary artery pressure readings.

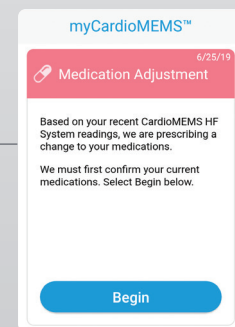

### Abbott

6101 Stoneridge Dr., Pleasanton, CA 94588 USA, Tel: 1 925 847 8600  
Cardiovascular.Abbott/CardioMEMS

### Rx Only

**Brief Summary:** Prior to using these devices, please review the Instructions for Use for a complete listing of indications, contraindications, warnings, precautions, potential adverse events and directions for use.

**CardioMEMS™ HF System Indications and Usage:** The CardioMEMS™ HF System is indicated for wirelessly measuring and monitoring pulmonary artery pressure and heart rate in NYHA Class II or III heart failure patients who either have been hospitalized for heart failure in the previous year and/or have elevated natriuretic peptides. The hemodynamic data are used by physicians for heart failure management with the goal of controlling pulmonary artery pressures and reducing heart failure hospitalizations.

**CardioMEMS™ HF System Contraindications:** The CardioMEMS HF System is contraindicated for patients with an inability to take dual antiplatelet or anticoagulants for one month post implant.

**CardioMEMS™ HF System Potential Adverse Events:** Potential adverse events associated with the implantation procedure include, but are not limited to, the following: air embolism, allergic reaction, infection, delayed wound healing,

arrhythmias, bleeding, hemoptysis, hematoma, nausea, cerebrovascular accident, thrombus, cardiovascular injury, myocardial infarction, death, embolization, thermal burn, cardiac perforation, pneumothorax, thoracic duct injury and hemothorax.

**myCardioMEMS™ Mobile App Limitations:** Patients must use their own Apple® or Android® mobile device to receive and transmit information to the myCardioMEMS™ Mobile App. To do so the device must be powered on, app must be installed and data coverage (cellular or Wi-Fi®) available. The myCardioMEMS™ App can provide notification of medication adjustments and reminders, requests for lab work and acknowledgement that the PA pressure readings have been received. However there are many internal and external factors that can hinder, delay, or prevent acquisition and delivery of the notifications and patient information as intended by the clinician. These factors include: patient environment, data services, mobile device operating system and settings, clinic environment, schedule/configuration changes, or data processing.

™ Indicates a trademark of the Abbott group of companies.

‡ Indicates a third-party trademark, which is property of its respective owner.

© 2023 Abbott. All Rights Reserved.

MAT-2009819 v2.0 | Item approved for U.S. use only.

